

ARDMORE

STUDIOS



STUDIO INFORMATION
AND STAGE PLANS

ardmore.ie

ARDMORE

STUDIOS



Ardmore House

Ardmore Studios is an 18 acre, multi-stage production campus, offering six soundproof stages, plus a further two stages at the adjacent Ardmore Film Factory. With over 90,000sqft of highly flexible, creative space available, Ardmore Studios is the perfect choice for productions of all size and genre.

Our selection of studios, ranging from 3000sqft to over 23,000sqft, plus a wealth of ancillary facilities, including production offices, workshops and backlot areas, provides film makers with a huge choice of production spaces. Ardmore Studios is also home to Ireland's only underwater filming facility. The addition of world class onsite support, including extensive lighting facilities, makes us the ideal self-contained solution.

Located just 12 miles/19km south of Dublin city in the coastal town of Bray, Co Wicklow, Dublin Airport, is just 30 minutes by car. Known as the 'garden of Ireland', Wicklow offers access to dozens of beautiful and historic film locations, all linked by an excellent transport network.

Filming from countryside to coast, or lakes to city centres, at Ardmore Studios no part of Ireland is ever far away.

ARDMORE

STUDIOS

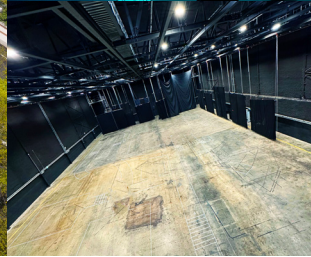

ARDMORE

STUDIOS

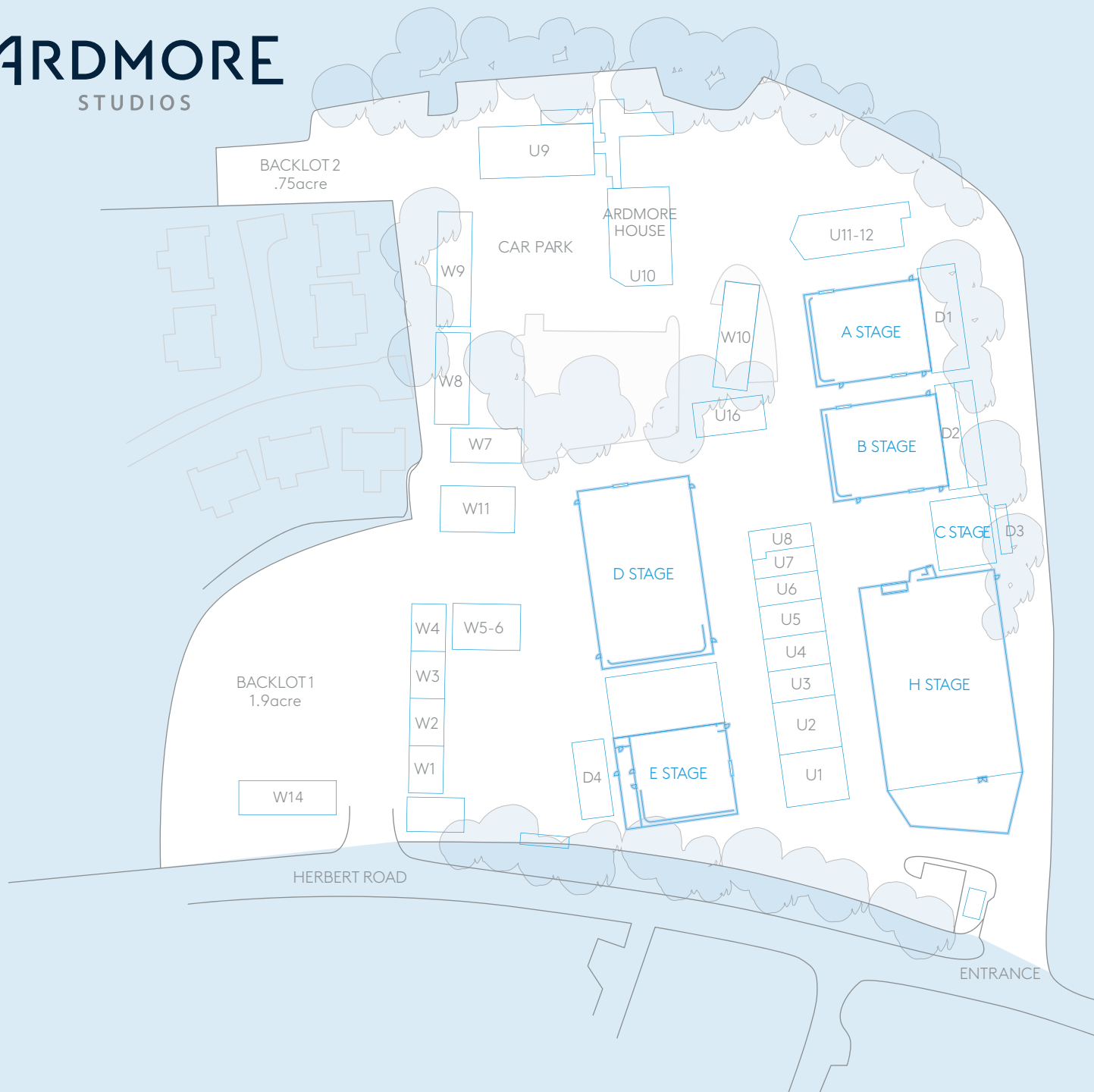

STUDIO MAP

- A STAGE** - 8000sqft/743.2m²
- B STAGE** - 8000sqft/743.2m²
- C STAGE** - 3000sqft/278.7m²
- D STAGE** - 15000sqft/1396.79m²
- E STAGE** - 6300sqft/585.28m²
- H STAGE** - 20800sqft/1940m²

- W** - Workshops
- U** - Units and Production Offices
- D** - Dressing Rooms

Ardmore Studios
 Herbert Road
 Bray
 Co Wicklow
 Ireland
 A98 C3C6
 +353 1 286 2971
film@ardmore.ie

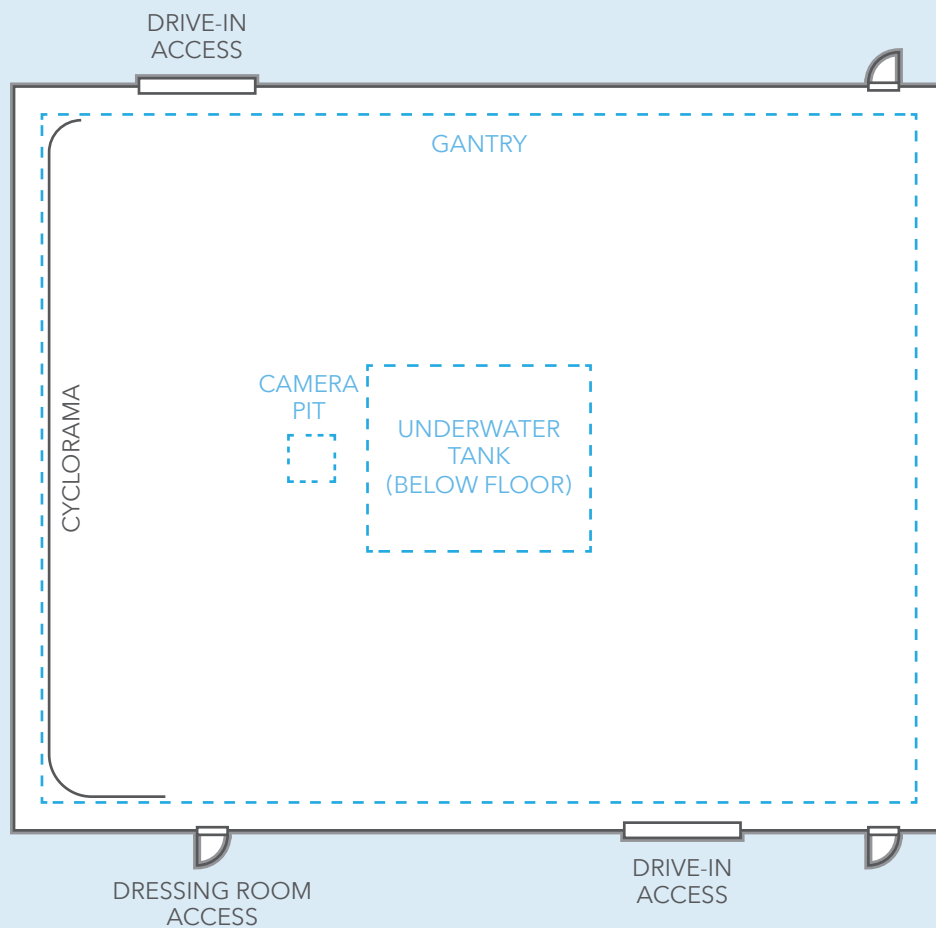

A STAGE

8000sqft/743.2m²

- Underground tank plus camera pit
- Full width cyclorama
- Drive in access
- Gantry
- Single/three phase power
- Catering area
- Direct access to dressing rooms

FLOOR AREA

100' x 80'/30.48 x 24.38m

FLOOR AREA - EXCLUDING BELOW GANTRY

94' x 74'/28.65 x 22.5m

WORKING HEIGHT

28' 6"/8.68m

HEIGHT TO GANTRY

17' 9"/5.41m

STAGE DOOR

12' 6" x 12' 6"/3.81 x 3.81m

TANK

24' x 20' x 9'/7.31 x 6.09 x 2.74m

TANK CAPACITY

26,829 gallons/121,970 litres

CAMERA PIT

5' x 5' x 9'/1.52 x 1.52 x 2.74m

CYC WIDTH

72' 9"/22.17m

Note: Cyc sits 3' 0"/0.91m from wall, to full working height and extends to a depth of 12' 6"/3.81m to the right and 3' 6"/1.05m to the left

POWER

single/three phase

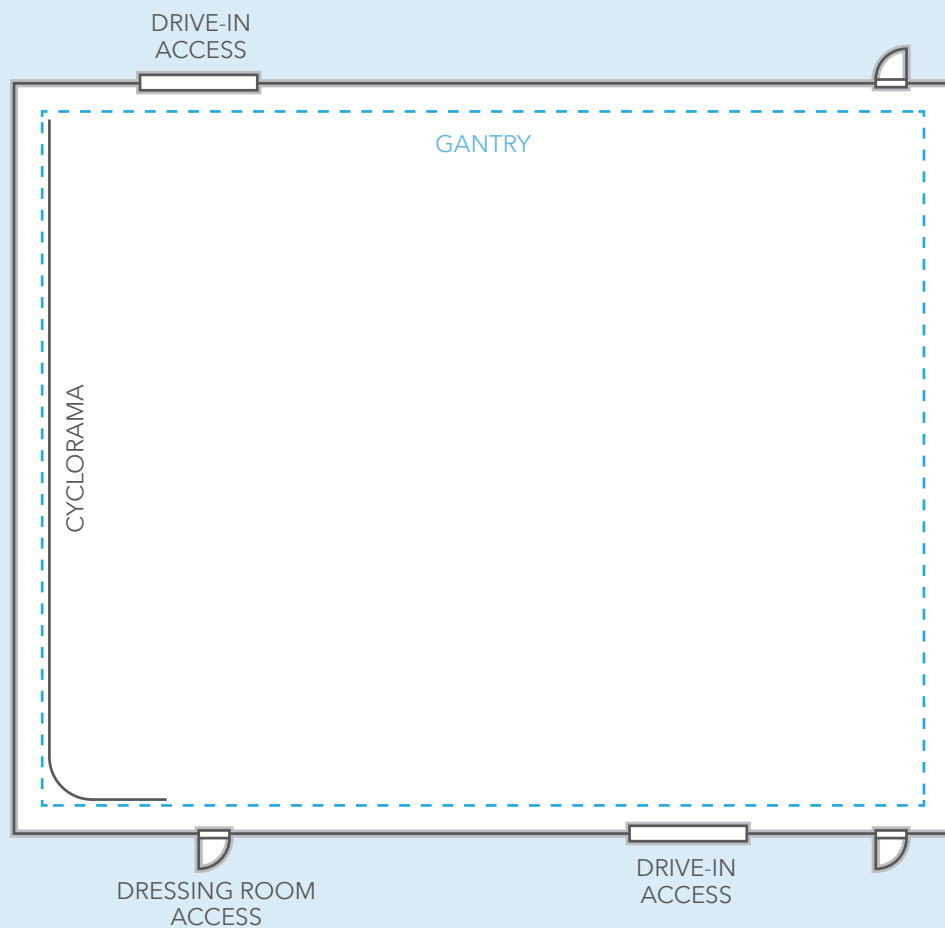

B STAGE

8000sqft/743.2m²

- Cyclorama
- Drive in access
- Gantry
- Single/three phase power
- Catering area
- Direct access to dressing rooms

FLOOR AREA

100' x 80'/30.48 x 24.38m

FLOOR AREA - EXCLUDING BELOW GANTRY

94' x 74'/28.65 x 22.5m

WORKING HEIGHT

28' 6"/8.68m

HEIGHT TO GANTRY

17' 9"/5.41m

STAGE DOOR

12' 6" x 12' 6"/3.81 x 3.81m

CYC WIDTH

72' 9"/22.17m

Note: Cyc sits 3'/0.91m from wall, to full working height and extends to a depth of 12' 6"/3.81m to the left side

POWER

single/three phase

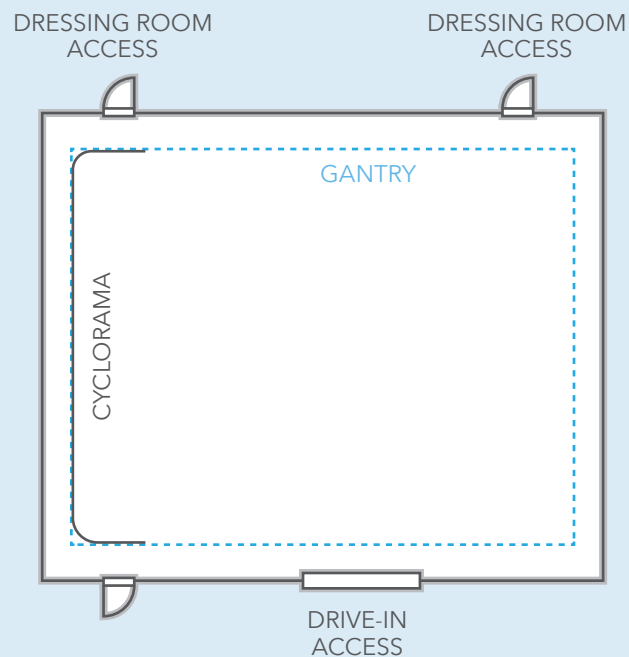

C STAGE

3000sqft/278.7m²

- Full width cyclorama
- Drive in access
- Gantry
- Single/three phase power
- Catering area
- Direct access to dressing rooms

FLOOR AREA

60' x 50'/18.28 x 15.24m

FLOOR AREA - EXCLUDING BELOW GANTRY

53' 6" x 43' 6"/16.30 x 13.25m

WORKING HEIGHT

24'/7.31m

HEIGHT TO GANTRY

15'/4.57m

STAGE DOOR

11' x 11' 6"/3.35 x 3.81m

CYC WIDTH

42' 6"/12.95m

CYC HEIGHT

18' 3"/5.56m

Note: Cyc sits 3'/0.91m from wall and extends to a depth of 8'/2.4m

POWER

single/three phase

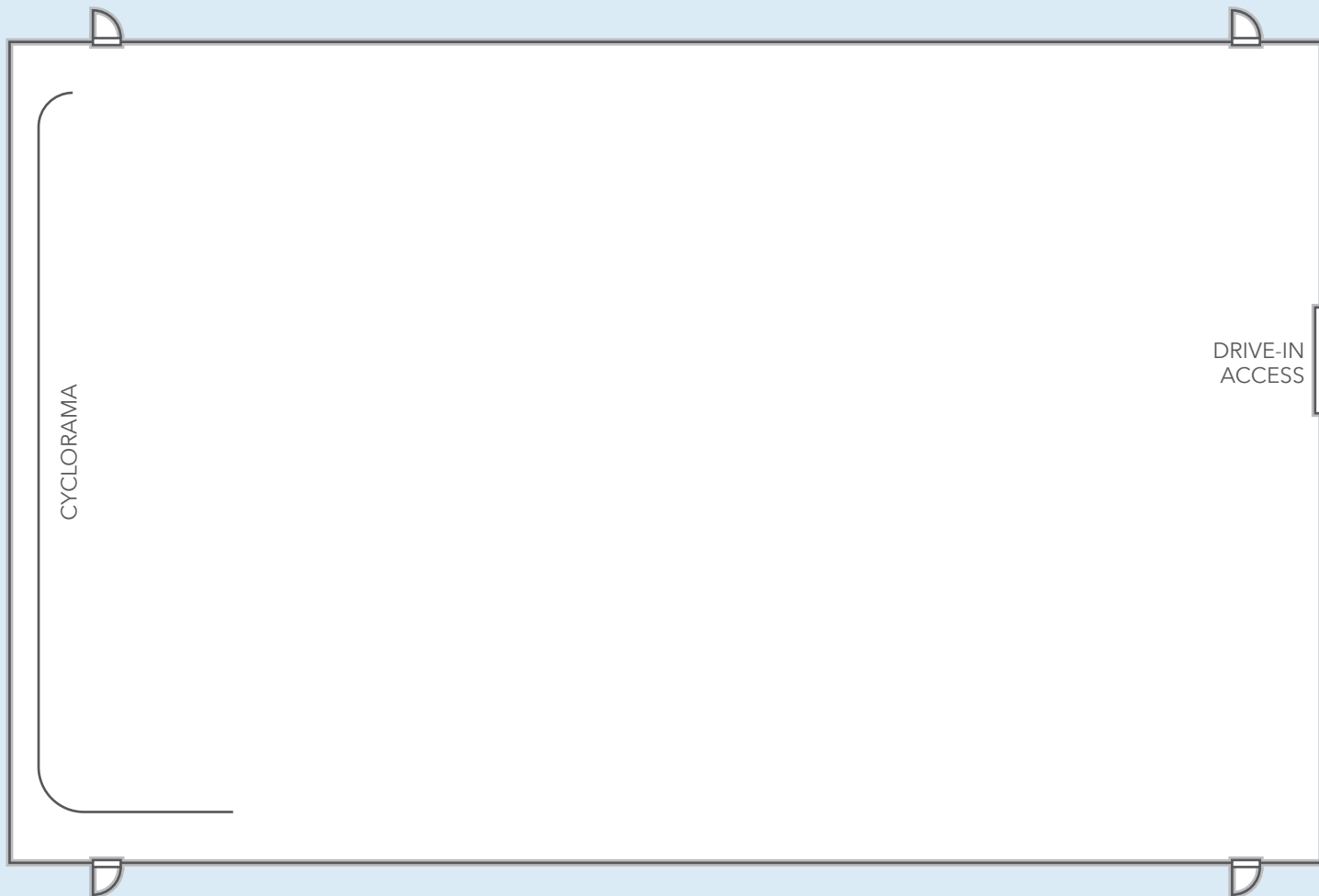

D STAGE

15,000sqft/1396.79m²

- Full width canvas cyclorama
- Drive in access
- Single/three phase power
- Catering area

FLOOR AREA

155' x 97'/47.24 x 29.56m

WORKING HEIGHT

35'/10.66m

STAGE DOOR

17' 5' x 17' 4"/5.3 x 5.3m

CYC WIDTH

85'/25.9m

Note: Cyc sits 10'/3.04m from wall, to full working height and extends to a depth of 3'/0.91m to the right and 23'/7m to the left

POWER

single/three phase

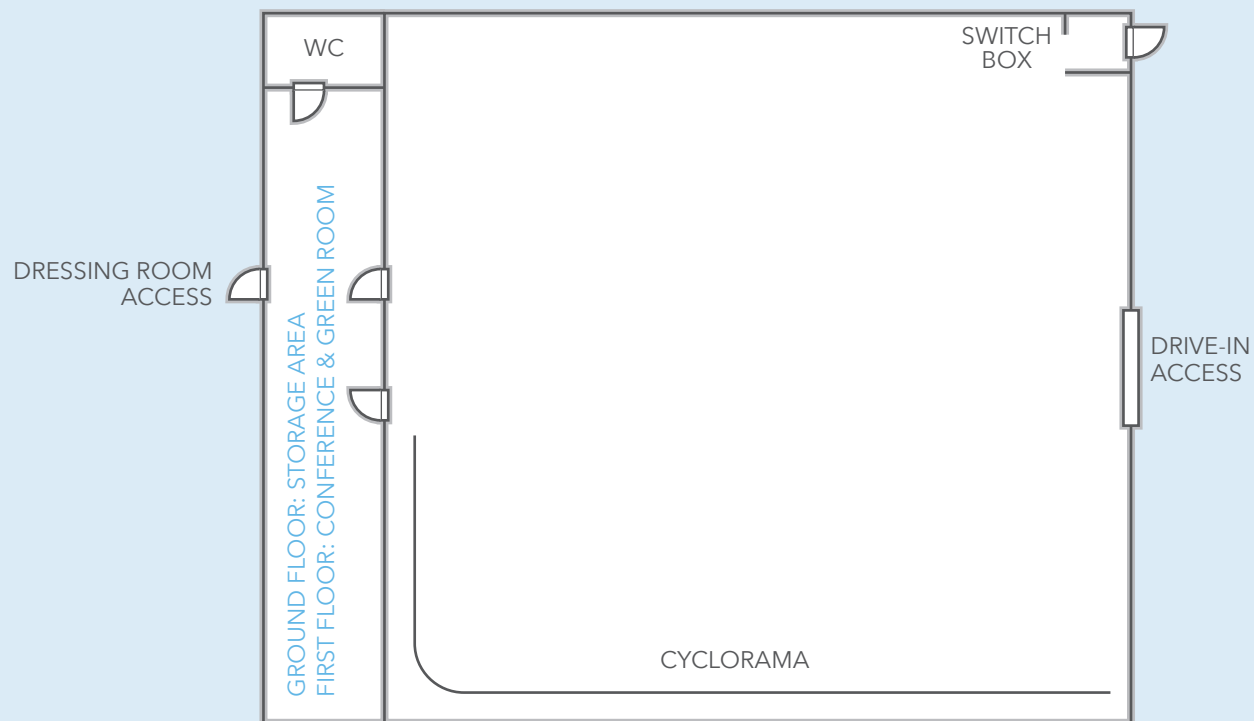

E STAGE

6300sqft/585.28m²

- Cyclorama
- Drive in access
- Single/three phase power
- Catering area
- Conference and green room

FLOOR AREA

89 x 68' 6"/24.68 x 23.46m

WORKING HEIGHT

20' 6"/6.24m

STAGE DOOR

13' x 13' 1"/3.96 x 4m

CYC WIDTH

28'/8.53m

Note: Cyc sits 3'/0.91m from wall, to full working height and extends to a depth of 8' 6"/2.6m

POWER

single/three phase

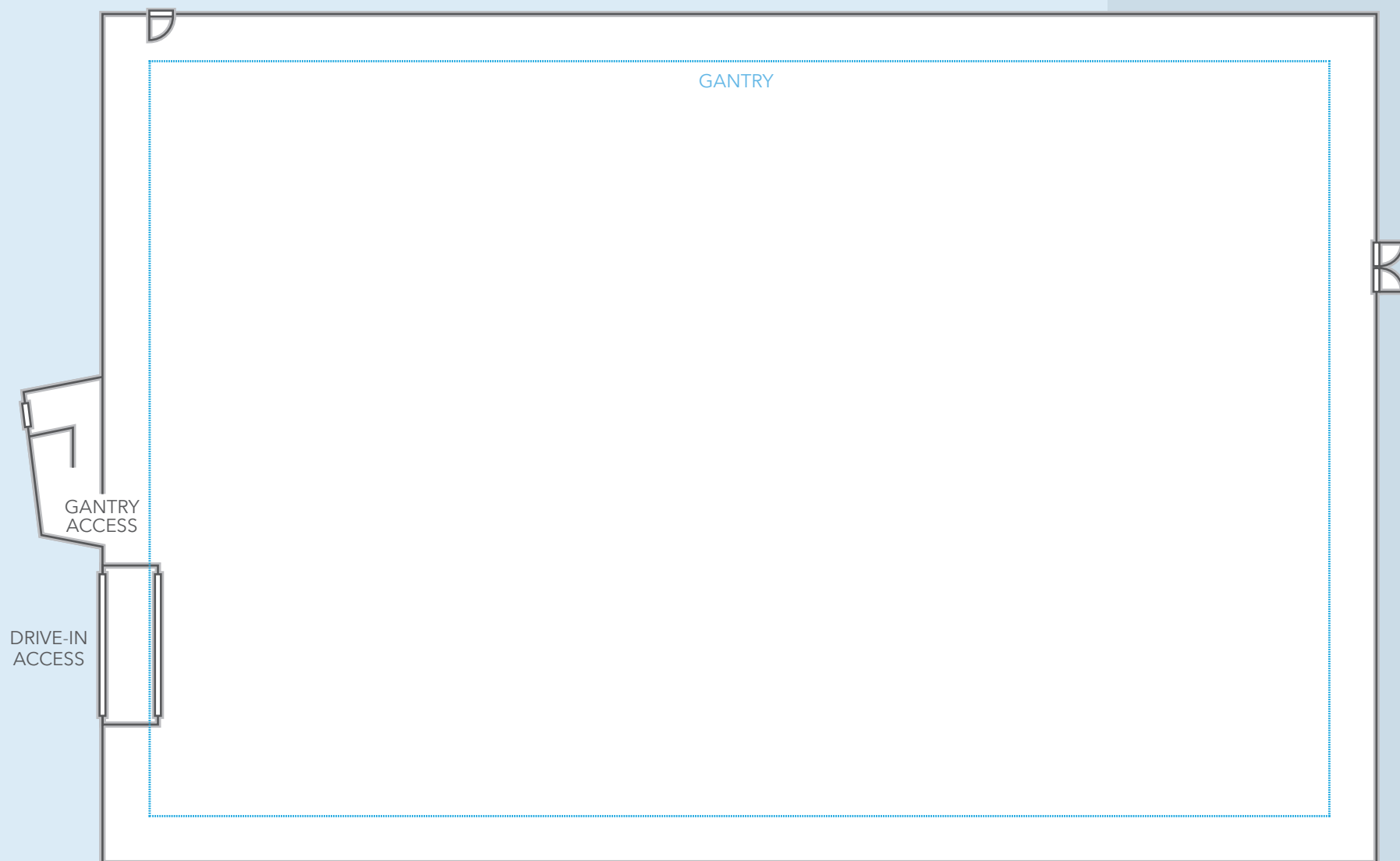

FLOOR AREA 178' x 118'/54 x 36m

WORKING HEIGHT (TO GRID) 43'/13m

STAGE DOOR 17' 5' x 17' 4"/5.75 x 5.3m

POWER single/three phase

- Largest soundstage on lot
- Lighting Grid/gantry
- Drive in access
- Single/three phase power
- Extensive production/Support space

ARDMORE

STUDIOS

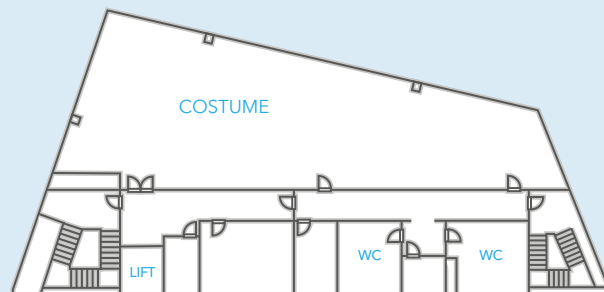

Second Floor

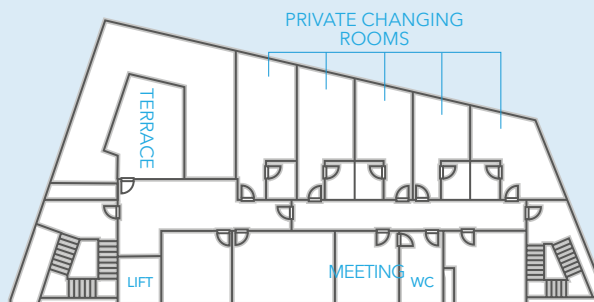

Fourth Floor

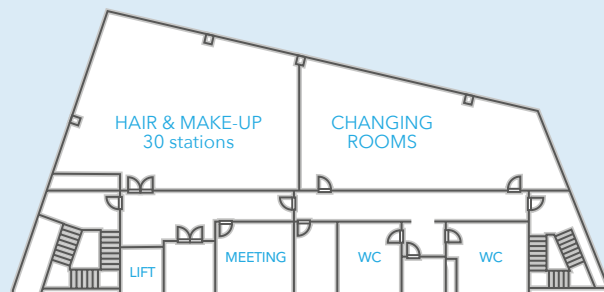

First Floor

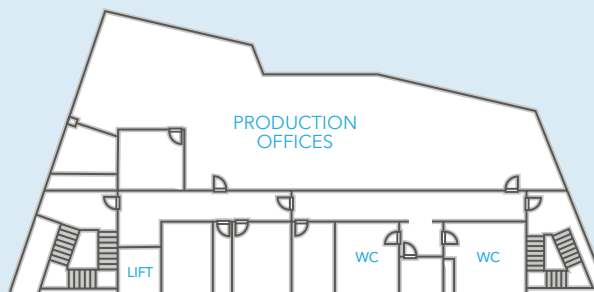

Third Floor

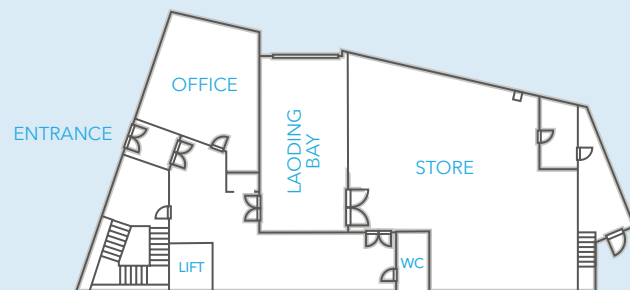

Ground Floor

H STAGE

Production Offices
and Ancillary Support Space

- Costume/Sewing
- Direct Access to H Stage
- Drive In Loading Bay
- Extras changing space
- Green Room
- Hair and Make Up
- Kitchen
- Male/Female/Accessible WCs
- Meeting Room
- Private Changing Space
- Production Office
- Self Contained
- Storage Area
- Private Roof Terrace

ARDMORE

FILM FACTORY



Ardmore Film Factory is a self-contained, 2 stage, production facility located just 5 minutes south of Ardmore Studios.

Ideal for both standalone use, or in conjunction with the main studio campus, Ardmore Film Factory offers clients over 30,000sqft of additional creative space, plus 11,000sqft of production offices.

Occupying a site of approximately 5.5 acres, the facility is directly adjacent to the Kilruddery Estate, which places it in a secluded, undisturbed location, backing onto green fields with quiet surroundings.



ARDMORE

FILM FACTORY

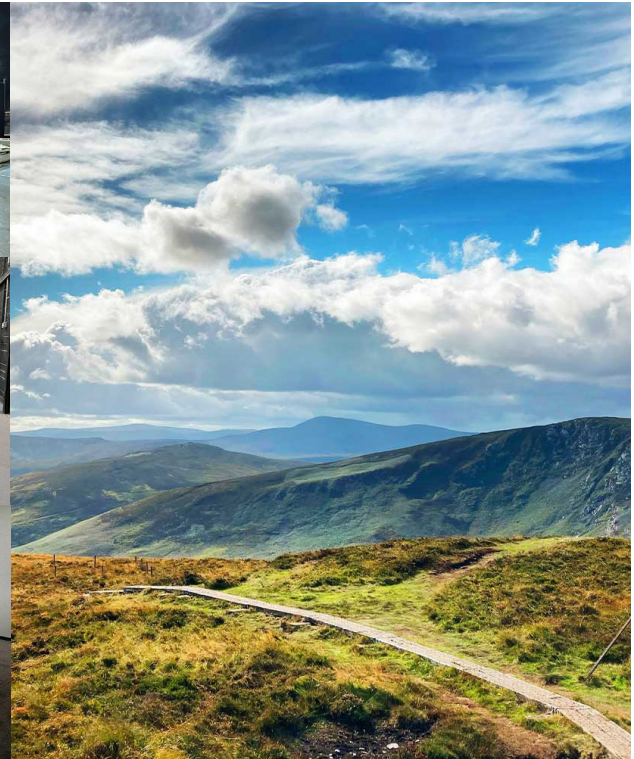

F STAGE
23,250sqft/2160m²

G STAGE
5812sqft/540m²

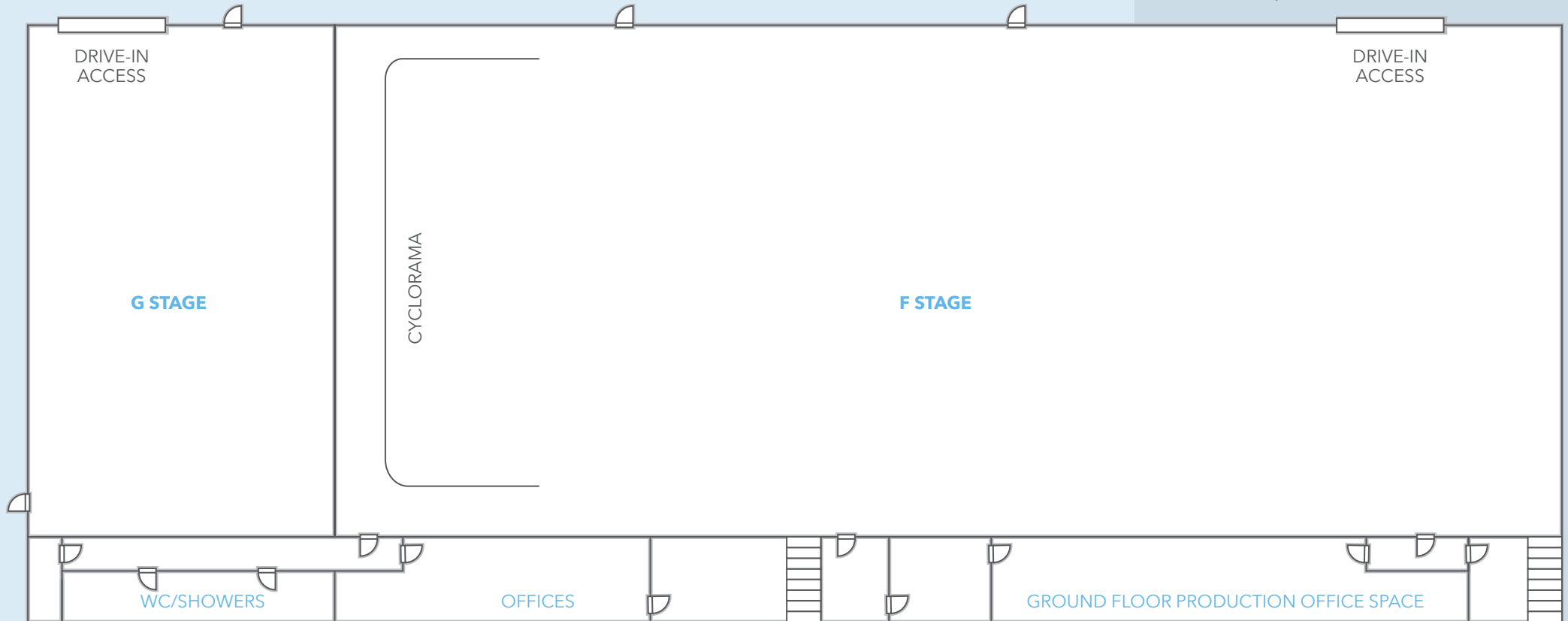

G STAGE

FLOOR AREA 59' x 98'/18 x 30m

WORKING HEIGHT 21'6.4m

STAGE DOOR 17' 5' x 17' 4"/5.33 x 5.3m

POWER single/three phase

F STAGE

FLOOR AREA 236' x 98'/72 x 30m

WORKING HEIGHT 21'6.4m

STAGE DOOR 17' 5' x 17' 4"/5.33 x 5.3m

POWER single/three phase

CYC (W X H X D) 70' x 20' x 30'/21m x 6m x 9m

Note: Cyc sits 3'/0.91m from right and rear walls, and 2'/0.6m from the left wall

- Available for individual or combined use
- Cyclorama (F stage)
- Drive in access
- Single/three phase power
- Catering area
- Production offices
- WC/Showers